

User Manual



CBTL™ is an easy to use, elegant, single serve beverage system, based on the proprietary Caffitaly System, that allows you to enjoy all the pleasures of an authentic *The Coffee Bean & Tea Leaf®* café beverage at home. One capsule is all you need to create a single serving to savor. One touch is all it takes to brew fresh, fragrant and flavorful espresso, brewed coffee or tea. One taste is enough to transport you to a moment of comfort—the comfort of one perfect cup.

One touch.
One perfect cup.

CBTL.com



One touch. One perfect cup.



KALDI Model S04



Table of contents

Important Safeguards	3
Your <i>CBTL</i> ™ System contact	4
Kaldi overview	5
Safety and indicator symbols	6
1 Priming machine before first use	7
2 Preparing your beverage	8
3 Indicator light guidelines	10
4 Programming quantity of beverage brewed	12
5 Resetting beverage settings	13
6 Programming energy saving function	14
7 Adjusting for different cup sizes	15
8 Daily maintenance	16
9 Descaling the machine	17
10 Draining the machine	21
11 Troubleshooting	22
12 Technical data	22
13 <i>CBTL</i> ™ Limited Warranty	23



IMPORTANT SAFEGUARDS

When using electrical appliances, basic safety precautions should be always followed, including the following:

1. Read all instructions
2. Do not touch hot surfaces. Use handles or knobs.
3. Do not use appliance for other than intended use. Appliance is for household use only (non commercial areas). Appliance is intended to prepare beverages according to these instructions. Use only *CBTL™/Caffitaly System* capsules. *CBTL™* assumes no liability for damages from use that is not in accordance with the instructions.
4. The use of accessory attachments not recommended by the appliance manufacturer may result in fire, electric shock or injury to persons.
5. Do not operate any appliance with a damaged cord or plug or after the appliance malfunctions, or has been damaged in any manner. Contact *CBTL™* for examination, repair or adjustment.
6. To protect against fire, electric shock and injury do not immerse cord, plugs, or appliance in water or other liquid.
7. Never touch cord with wet hands.
8. Do not overfill water tank.
9. Never put the appliance or part of the appliance into dishwasher.
10. Make sure that the power supply voltage matches the rating shown on the data plate on the bottom of the appliance.
11. Do not place on or near a hot gas or electric burner, or in a heated oven.
12. Do not use outdoors.
13. Close supervision is necessary when any appliance is used by or near children. Brewer dispenses very hot water. Keep appliance, capsules and accessories out of reach of children.
14. Do not let cord hang over the edge of the table or counter, or touch hot surfaces.
15. Unplug from outlet when not in use and before cleaning. Never touch the cable with wet hands. Allow to cool before putting on, adding or removing parts, and before cleaning the appliance.
16. Scalding may occur if the lever is lifted during brewing cycles.
17. To disconnect, turn power switch to “off”, then remove plug from the power outlet.
18. This appliance is equipped with a power cord having a grounding wire with a grounding plug. The appliance must be grounded using a 3-hole properly grounded outlet. In the event of an electrical short circuit, grounding reduces the risk of electrical shock.
19. Do not, under any circumstances, cut or remove the third (ground) prong from the power cord or use an adapter.
20. To avoid an electrical circuit overload, do not use another high-wattage appliance on the same circuit with your *CBTL™ System*.



IMPORTANT SAFEGUARDS

21. Do not dismantle appliance and do not put anything into openings. Never put your hand inside space for capsules.
22. Consult a qualified electrician if the grounding instructions are not completely understood, or if doubt exists as to whether the appliance is properly grounded.
23. The CBTL™ System uses a short power-supply cord to prevent the cord from tangling and to reduce the risk of tripping over a long cord.
24. If a longer cord is necessary, an approved extension cord may be used.
 - The marked electrical rating of the extension cord must be equal to or greater than the rating of the appliance;
 - The longer cord should be arranged so that it will not drape over the countertop or tabletop where it can be pulled on by children or tripped over unintentionally;
 - The extension cord should be a grounding type 3-wire cord.
25. WARNING TO PARENTS AND USERS:
 - Keep all plastic bags away from children
 - **DO NOT** permit children to use brewer unless there is adult supervision.

WARNING: To reduce the risk of fire and electric shock, do not remove the side covers. No user serviceable parts inside. Repair should be done by an authorized service person only.



DISPOSAL AND ENVIRONMENTAL PROTECTION

- Your appliance contains valuable materials that can be recovered or recycled. Separation of the remaining waste materials into different types facilitates the recycling of valuable raw materials. Leave the appliance at the collection point. You can obtain information on disposal from your local authorities.
- The appliance and the packaging materials are made of high quality materials that can be reused or recycled.

SAVE THESE INSTRUCTIONS.

Pass them on to any subsequent user

Your CBTL™ System contact

Country	Contact Number	Email
USA	888-520-CBTL (888-520-2285)	info@cbtl.com

Visit CBTL.com for FAQs and instructional videos.

Kaldi Overview

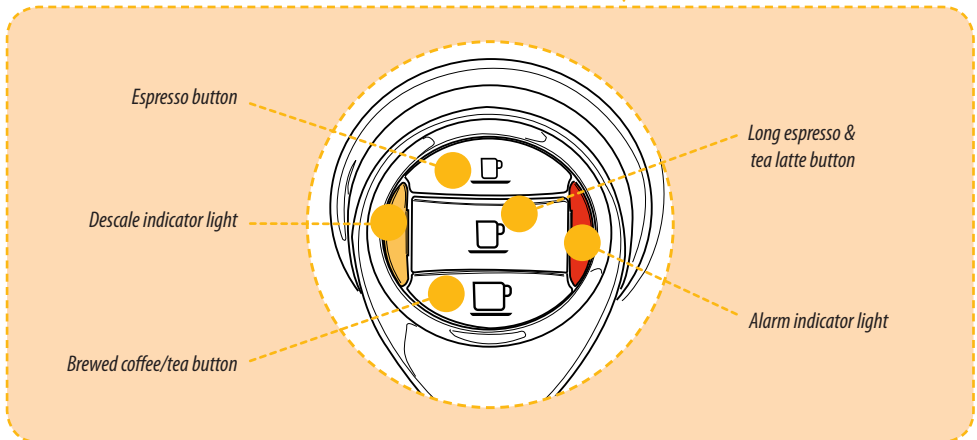
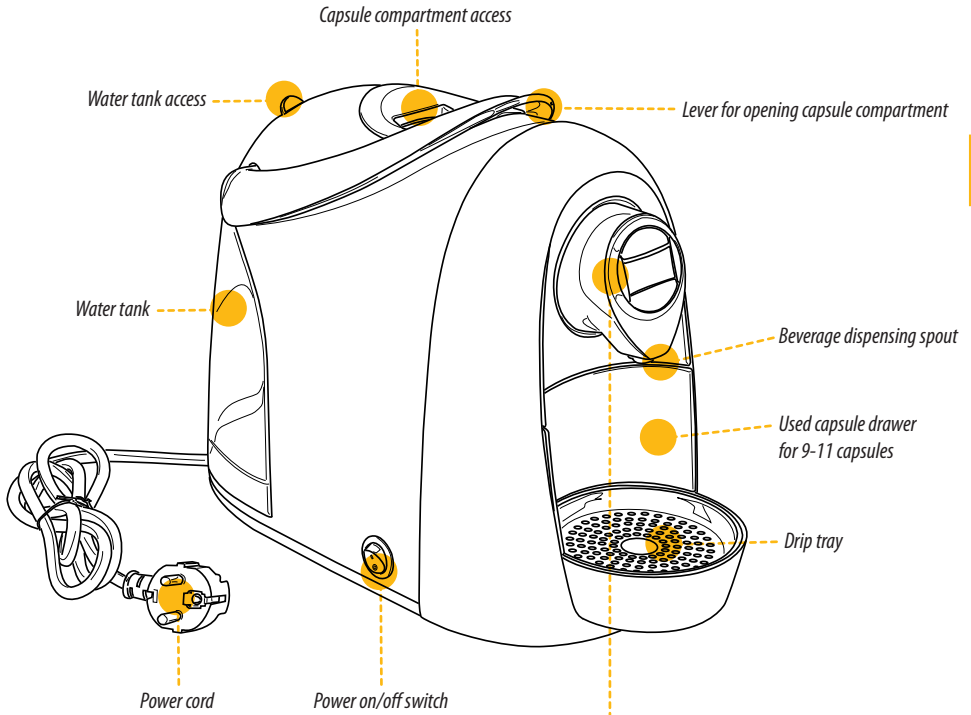

Safety and Indicator Symbols



CAUTION

This is a safety warning symbol used to call your attention to possible risks of personal injury.



NOTE

This symbol is used to highlight some actions that will optimize use of the appliance.



Dishwasher safe.



Not dishwasher safe.



This symbol is used to indicate a WHITE light.



This symbol is used to indicate a RED light.



This symbol is used to indicate an ORANGE light.

1

Priming machine before first use

1

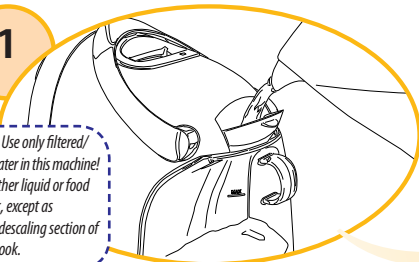

Warning! Use only filtered/
bottled water in this machine!
Do not put any other liquid or food
in the water tank, except as
instructed in the descaling section of
this instruction book.

Fill the water tank with filtered/bottled water.

2

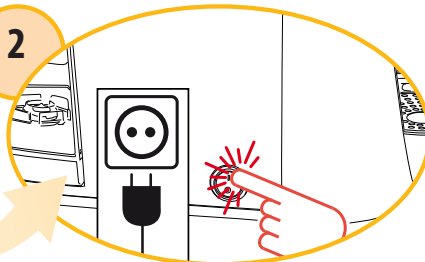

Plug into grounded outlet, then turn power switch on.

3

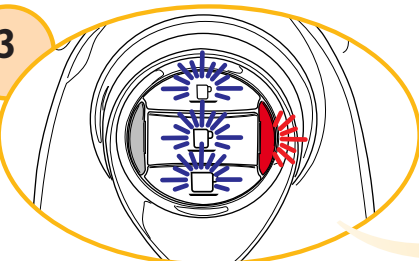

The beverage buttons and alarm indicator light will blink simultaneously.

4

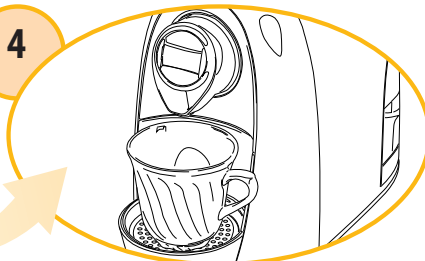

Place an ample container under the beverage dispensing spout.

5

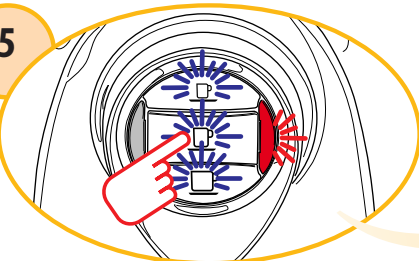

Press the long espresso button once. Wait approximately 2 minutes for the machine to complete the priming cycle. During this cycle, the alarm indicator light will blink. The alarm light will go off and the 3 beverage buttons will blink to confirm the end of the priming cycle. Repeat this step only if the alarm indicator light continues to blink.

6

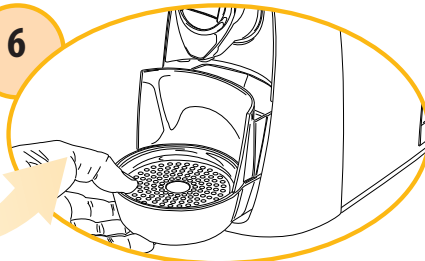

If required, empty water from the used capsule drawer. Your machine is now ready for use.

2

Preparing your beverage

1

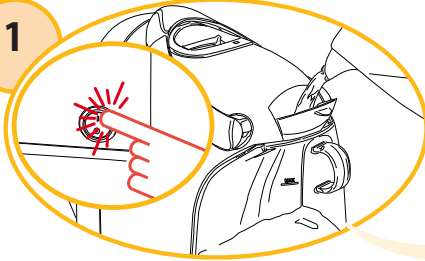

Fill the water tank with filtered/bottled water. Turn the appliance on.

2

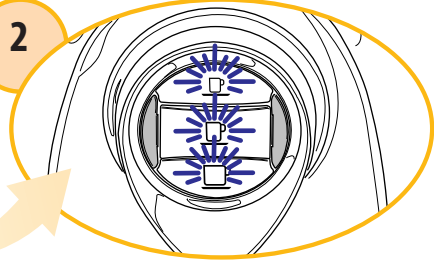

The beverage buttons will blink simultaneously to indicate that the machine is warming up. When the buttons remain steadily lit, the machine is ready for use.

 A frozen or extremely cold CBTL™ machine will not operate efficiently when exposed to temperature below freezing. Allow at least 2 hours to reach room temperature before brewing.

3

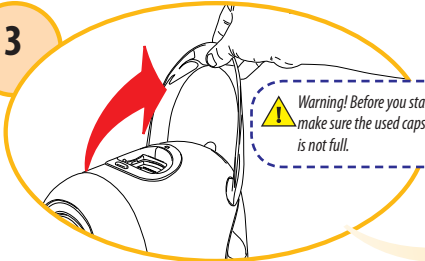

Raise the lever to open the capsule compartment.

 Warning! Before you start brewing, make sure the used capsule drawer is not full.

4

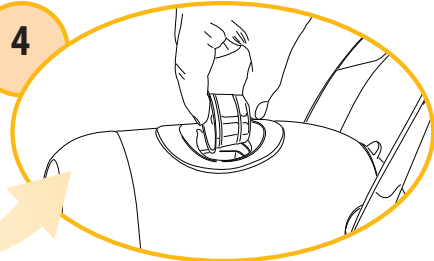

Insert the capsule, pressing it gently into place.

5

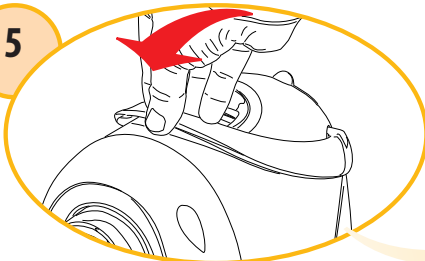

Close the lever firmly.

6



Place a cup or mug under the beverage dispensing spout.

2

Preparing your beverage



7

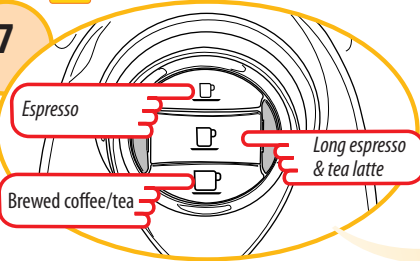

Press your desired beverage button.

8

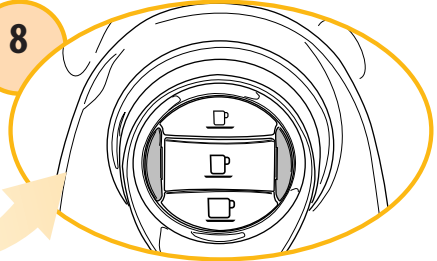

The selected beverage button will blink. The machine will stop dispensing beverage on reaching the programmed quantity, and beep.

9

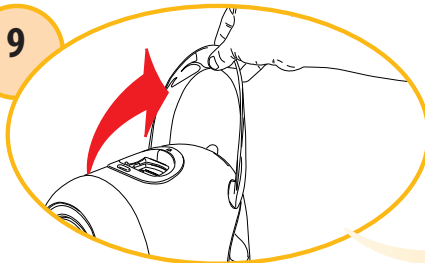

Raise lever to eject used capsule into the used capsule drawer.

10

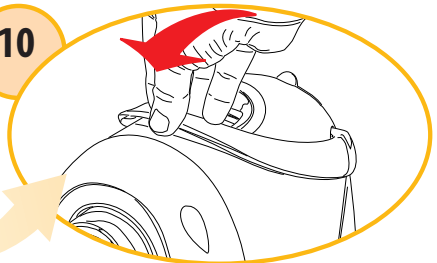

Close the lever.



NOTE:

The amount of beverage dispensed can be **reprogrammed** according to personal taste. Please refer to section 4 for reprogramming instructions.

When switching from one beverage to another, we suggest rinsing the machine by pressing a beverage button without inserting a capsule.

3

Indicator light guidelines

DESCALE INDICATOR

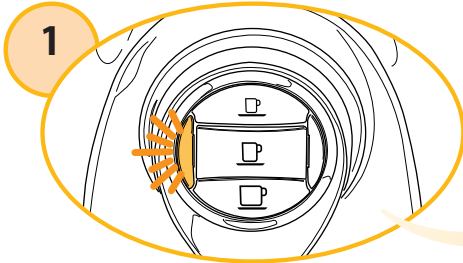

When the descale indicator light blinks and the machine beeps, it is advisable to carry out a descaling cycle.

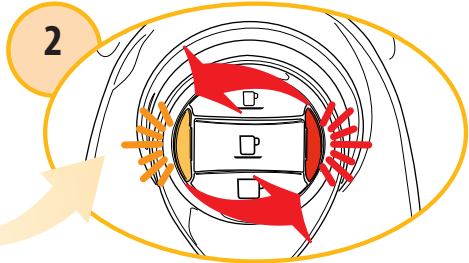

When the descale and alarm indicator lights blink alternately and the machine beeps, it is necessary to carry out a descaling cycle.

EMPTY WATER TANK INDICATOR

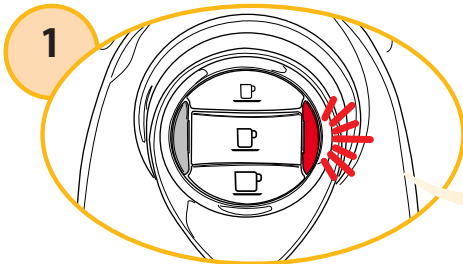

When the alarm indicator light blinks and the machine beeps, the water tank is empty.

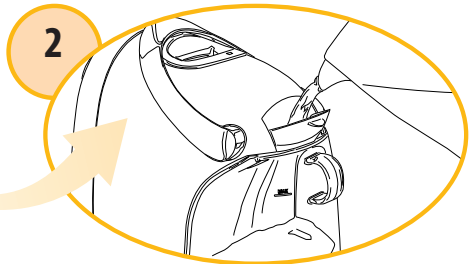

Fill the tank with filtered/bottled water.

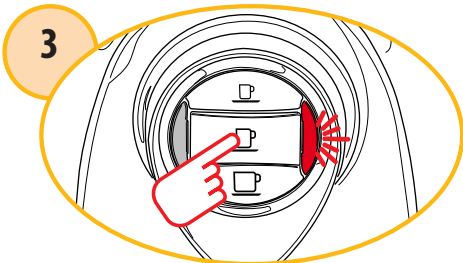

Press your desired beverage button to resume dispensing.

3

Indicator light guidelines

INTERRUPTED OPERATION INDICATOR

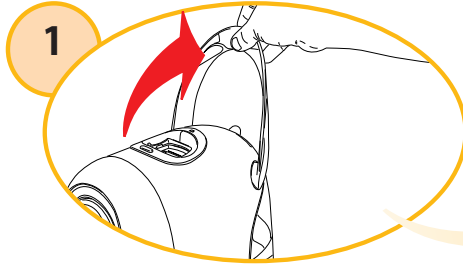

When the lever is raised while a beverage is being dispensed—

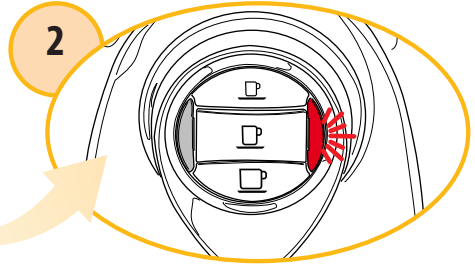

The alarm indicator light will blink and beep. The machine will immediately stop dispensing.

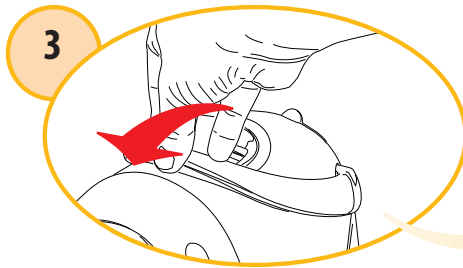

Close the lever.

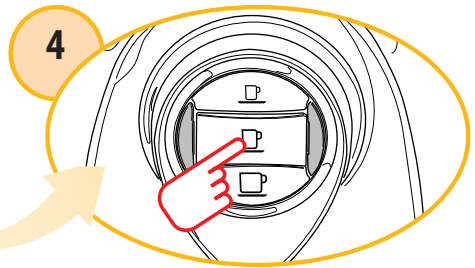

Press a beverage button to reset the alarm indicator light.

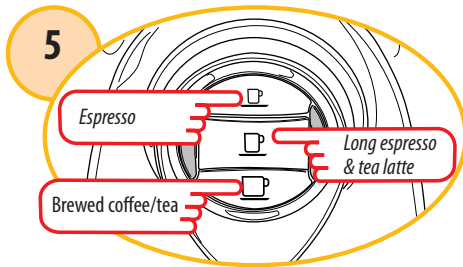

Press your desired beverage button to brew a new cup.

4

Programming quantity of beverage brewed

1

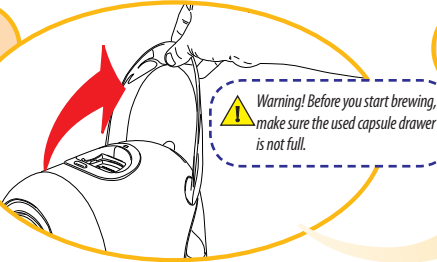

Raise the lever to open the capsule compartment.

2

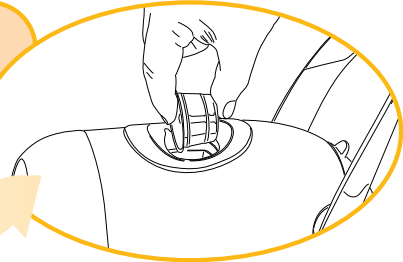

Insert the capsule, pressing it gently into place.

3

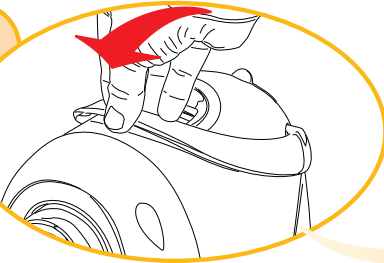

Close the lever firmly.

4



Place a cup or mug under the beverage dispensing spout.

5

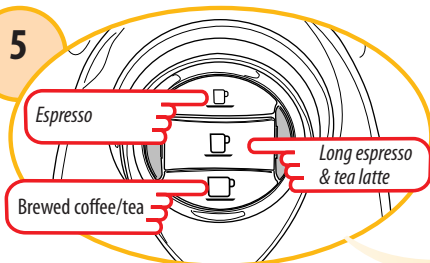

Keep your desired beverage button pressed down.

6

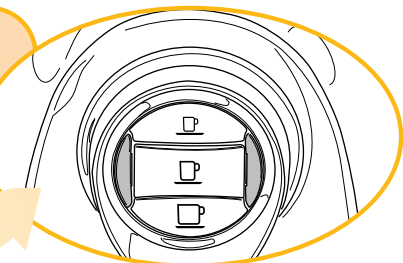

On reaching the desired amount of beverage, release the button. The button is now programmed. To reprogram the button or program another button, repeat the above steps.

5

Resetting beverage settings

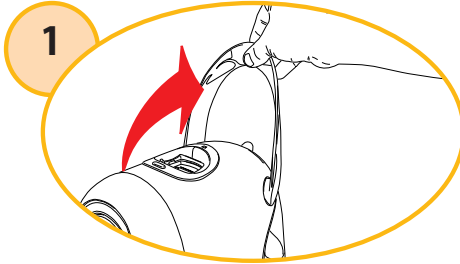

Turn machine off. Raise the lever to open the capsule compartment.

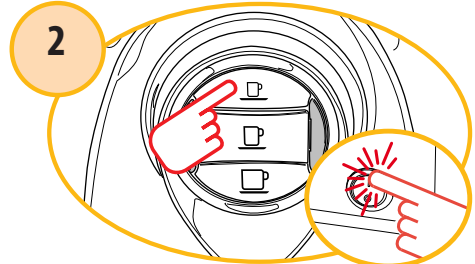

Press and hold down the espresso button while simultaneously switching the machine on.

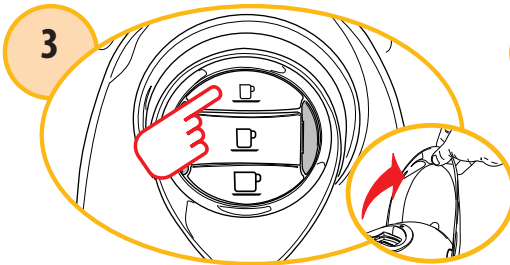

Continue to hold the espresso button and quickly close and open the lever. The machine will beep 5 times.

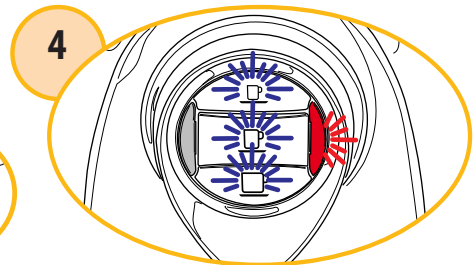

Release the espresso button. After a few seconds, the beverage buttons and alarm indicator light will blink.

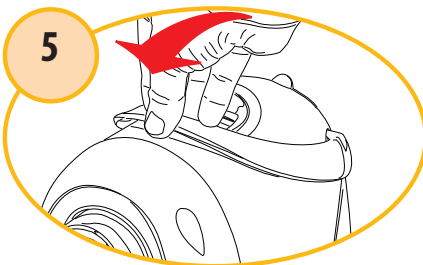

Close the lever.

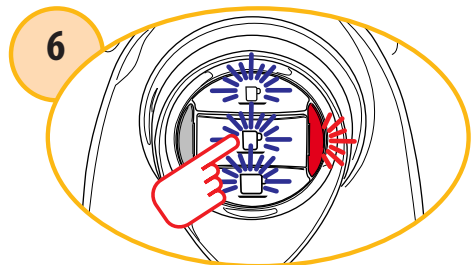

Place a cup on the drip tray. Press the long espresso button once. Wait approximately 2 minutes. The cycle is complete when the 3 buttons are steadily lit. Repeat this step only if alarm light continues to blink.

6

Programming energy saving function

The Kaldi features an energy saving function (normally activated) which automatically reduces energy consumption by approximately 98% one hour after last use. To deactivate (or reactivate) this function, proceed as follows:

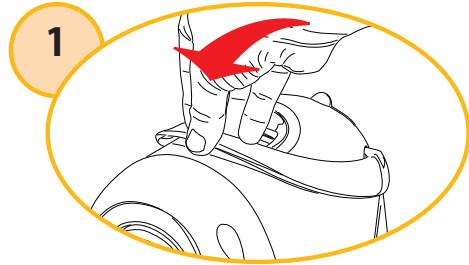

Make sure the lever is lowered.

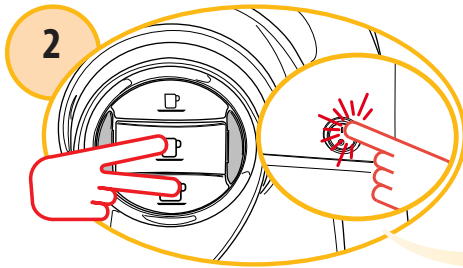

Keep long espresso and brewed coffee/tea buttons pressed down and simultaneously switch machine on.

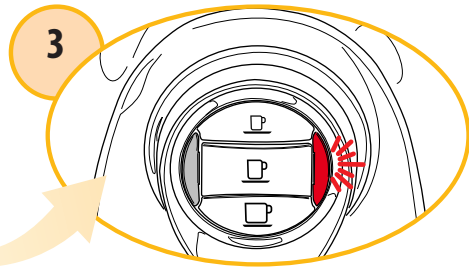

The alarm indicator light will blink and beep three times to confirm deactivation of the "Energy Saving" function. When the function is reactivated, the alarm indicator light will blink and beep two times.

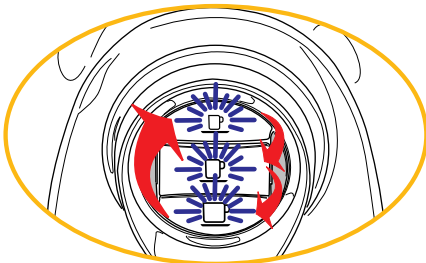

Once the "Energy Saving" function has been programmed, the machine will automatically reduce consumption one hour after last use. The beverage buttons will blink cyclically during energy saving mode.

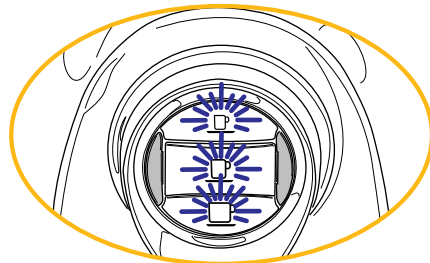

To restore normal operating conditions, press any beverage button or raise the lever. The machine will warm up. When the machine is ready for use, the beverage buttons will be steadily lit.

7

Adjusting for different cup sizes

1



The machine is initially set for use of 10 ounce cups/mugs.

2

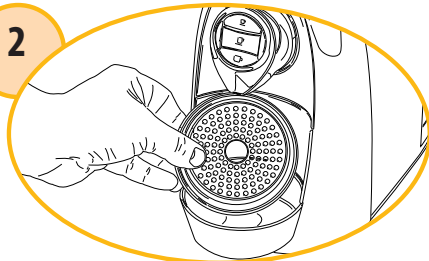

To use espresso cups, lift and turn the grill on top of the drip tray.

3



The grill must be positioned over the drip tray turned.

4



Your machine is now set for use of espresso cups.

8

Daily maintenance

1

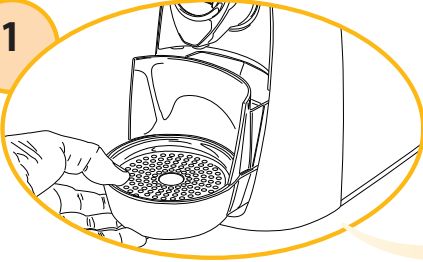

Remove the drip tray and used capsule drawer.

2



Lift the used capsule drawer, empty and rinse.

3

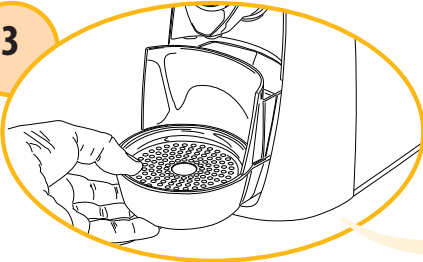

Remove the grill. Empty the drip tray and rinse it with fresh water.

4

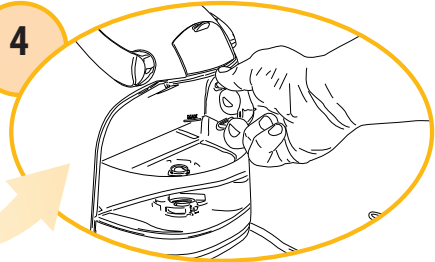

Remove the water tank. Empty and rinse.
NOTE: The water tank is **NOT** dishwasher safe.



Use a soft, dampened cloth to clean the surfaces of the machine.



The plastic parts of the machine are not dishwasher safe.

9

Descaling the machine



Mineral content present in most of the water sources causes calcium deposits or scale to build up in your machine. The Kaldi features an advanced program that detects when it needs to be descaled. Refer to section 3 for descale indicator guidelines.



Carefully read the directions for use on the package of the descaling agent.
Avoid contact with eyes, skin and machine surfaces.
Do not use vinegar: it could damage your appliance!
During descaling, do not turn the machine off.

CBTL™ recommends using the CBTL™ Descaler to descale your machine.

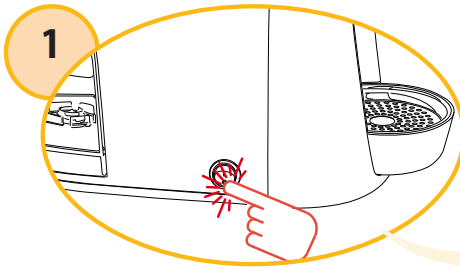

Turn the machine off.

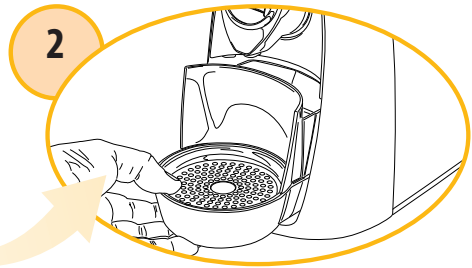

Empty and rinse out the used capsule drawer and drip tray.

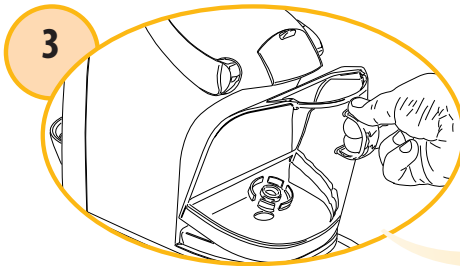

Remove and empty the water tank.

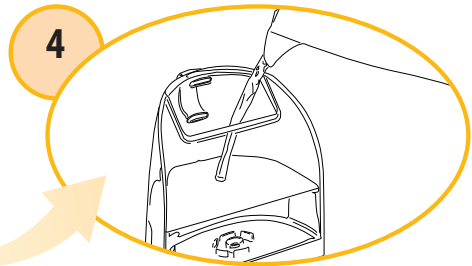

Prepare the descaling solution following the manufacturer's directions and pour a liter of solution into the tank.

9

Descaling the machine

5



Place a container under the beverage dispensing spout.

6

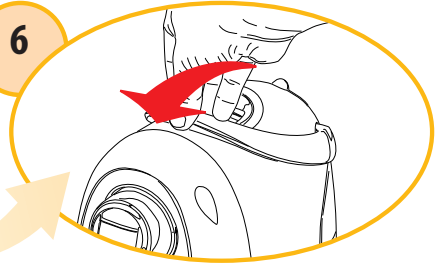

Make sure the lever is lowered.

7

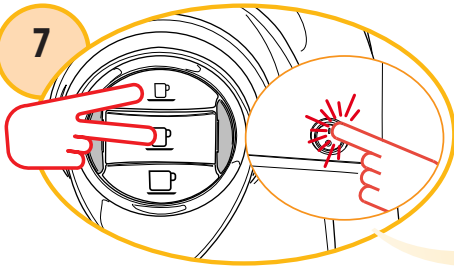

Keep the espresso and long espresso buttons pressed down and simultaneously switch the machine on.

8

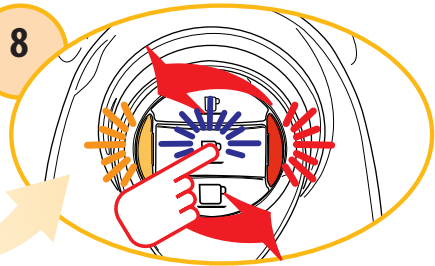

The long espresso button and the descale and alarm indicator lights blink alternately. Press the long espresso button to start the descale cycle.

9

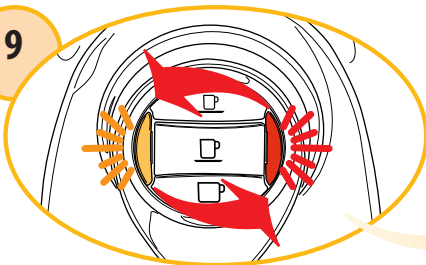

The machine delivers descaling solution at intervals of approximately 10 minutes. During this cycle, the descale and alarm indicator lights blink alternately.

10

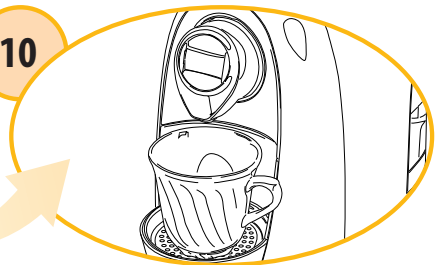

If the container fills up, empty it out. The descale cycle lasts for approximately 40 minutes.

9

Descaling the machine

11

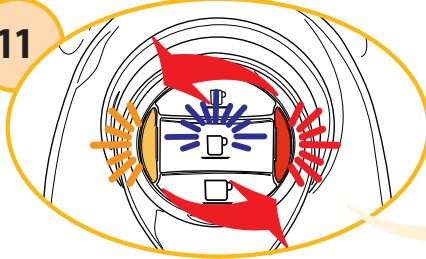

At the end of a descale cycle, the long espresso button and the descale and alarm indicator lights blink alternately.

12

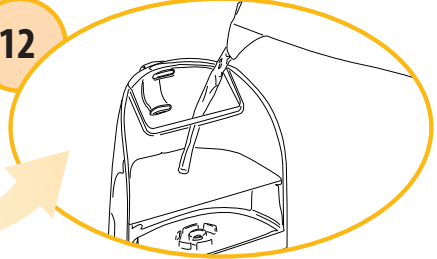

Carefully rinse out the water tank and fill it with filtered/bottled water.

13

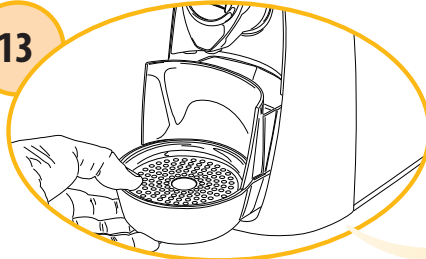

Empty and rinse out the used capsule container and drip tray.

14

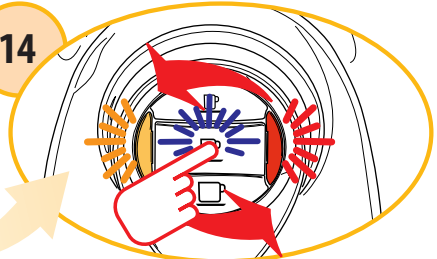

The long espresso button and the descale and alarm indicator lights blink alternately. Press the long espresso button to start the prime/rinse cycle.

15

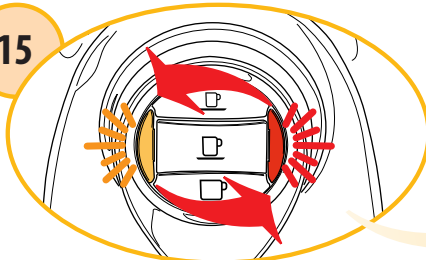

Water will rinse through the machine. During this cycle the descale and alarm indicator lights blink alternately.

16



If the container fills up, empty it out and replace until the prime/rinse cycle is complete.

9

Descaling the machine

17

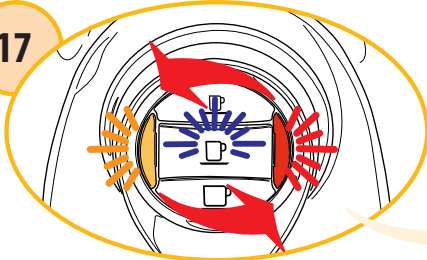

At the end of the prime/rinse cycle, the long espresso button and the descale and alarm indicator lights blink alternately and the machine beeps.

18

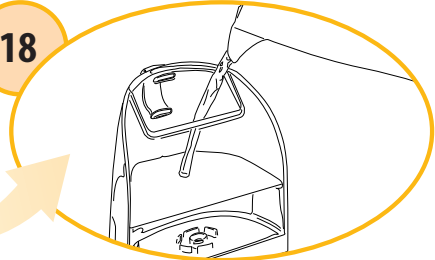

Carefully rinse out the water tank and fill it with filtered/bottled water.

19

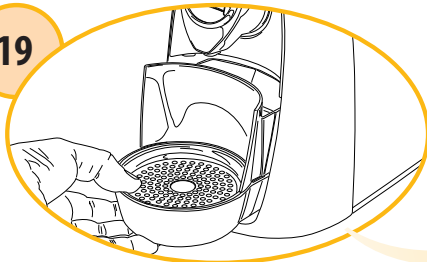

Empty and rinse out the used capsule drawer and drip tray.

20



Press the long espresso button to exit the prime/rinse cycle.



Use a soft, dampened cloth to clean the surfaces of the machine.

10

Draining the machine



CAUTION - When the machine is not used for a long time, it is necessary to drain the water lines. Liquids may freeze and damage the machine.

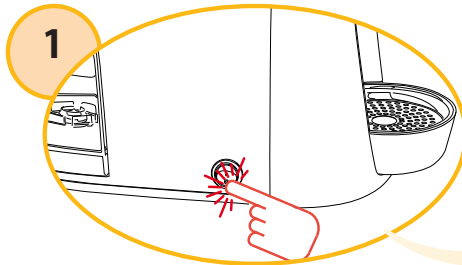

Turn the machine off.

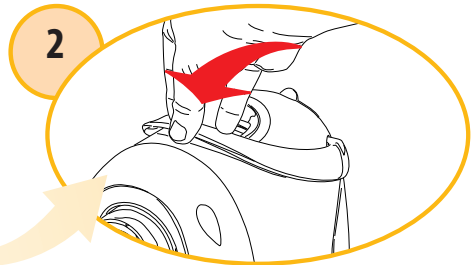

Make sure the lever is lowered.

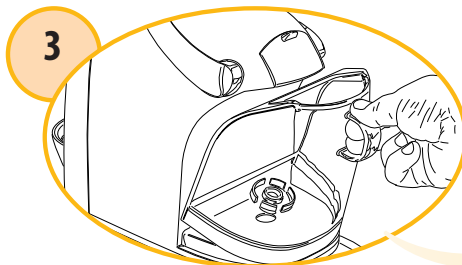

Remove and empty out the water tank.

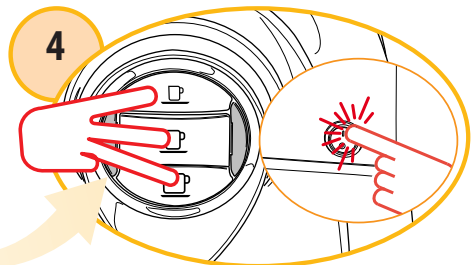

Keep the beverage buttons pressed down and simultaneously switch the machine on.

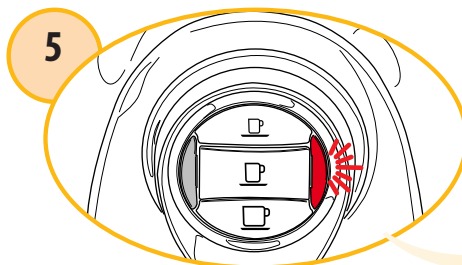

The alarm indicator light will blink and the machine will carry out a drainage cycle. The machine will beep at the end of this cycle.

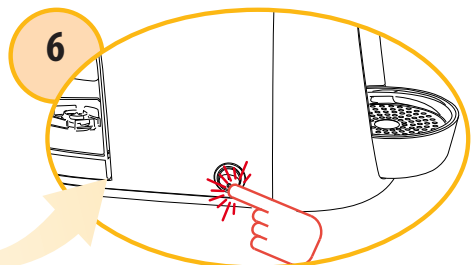

Turn the machine off. Before next use, follow instructions to prime the machine as indicated in section 1.

11

Troubleshooting

Problem	Cause / Solution
No beverage is brewed.	The water tank is empty, the alarm indicator light is on and red. ► Fill the tank with filtered/bottled water. Press the desired beverage button. The machine will resume brewing.
The beverage is not hot enough.	Cold cups / mugs. Scale build-up in machine. ► Preheat the cup. Descale the machine.
The lever cannot be lowered.	The used capsule drawer is full. Capsule stuck inside the machine. ► Empty out the used capsule drawer. Remove the used capsule.

Beyond the recommended cleaning and maintenance procedures, the CBTL™ machine is not user serviceable. For additional options, please refer to the CBTL™ Limited Warranty.

12

Technical data

	See the data plate on the bottom of the machine
P	Max. 15 bar
	approx. 4 kg, 8.8 lb
	1.2 liters, 40.6 oz
	5 °C - 15 °C 5 °C - 15 °C
	170 mm 296 mm 260 mm

CBTL™ warrants this product against defects in materials and workmanship under normal home use for 1 year from the date of purchase. The warranty period commences on the date of purchase and CBTL™ requires presentation of the original receipt to ascertain this date.

During the warranty period, CBTL™ will either repair or replace, at its option, any defective product at no charge to the owner provided that you return your product, at your sole cost and expense, in accordance with the CBTL™ Limited Warranty Claims Process. Unless otherwise required under applicable law, replacement products will be warranted only for the unexpired portion of the original warranty.

This limited warranty does not apply to cosmetic damage or any defect resulting from accident, negligence, misuse, failure to follow the product instructions, calcium deposits, improper or inadequate maintenance or repair by anyone other than CBTL™, normal wear and tear, use for commercial purposes, use on current or voltage other than as marked on the product, product alteration, fire, lightning, flood or other external causes.

To the extent permitted by applicable law, this limited warranty does not cover consequential or incidental damages such as property damage.

This limited warranty is only valid in the country of purchase.

The terms of this limited warranty do not exclude, restrict or modify mandatory statutory rights, if any, applicable to the sale of this product in your country of purchase.

If you believe your product is defective, contact CBTL™ support service based on your country of purchase or visit our website at cbtl.com for contact details.

IMPORTANT INFORMATION:

IF YOUR MACHINE NEEDS TECHNICAL ATTENTION, PLEASE CONTACT CBTL™ SUPPORT SERVICE FOR YOUR COUNTRY OF PURCHASE, SET FORTH BELOW.

DO NOT RETURN THIS MACHINE TO YOUR RETAILER

Register your machine online today at:

cbtl.com/RegisterYourMachine.aspx

Visit our website to view our Limited Warranty Claims Process.

Country	Contact Number	Email
USA	888-520-CBTL (888-520-2285)	info@cbtl.com
Singapore	+65 6273-2221	CBTL@coffeebean.com.sg
Malaysia	(603) 92001833	CBTL@coffeebean.com.my
Korea	82-2-548-0552	CBTL@coffeebeankorea.com
UAE	+971 4 3539500	CBTL@coffeebean.ae

One touch. One perfect cup.



Order online at
CBTL.com